

1:100 GROUND FLOOR SETTING OUT

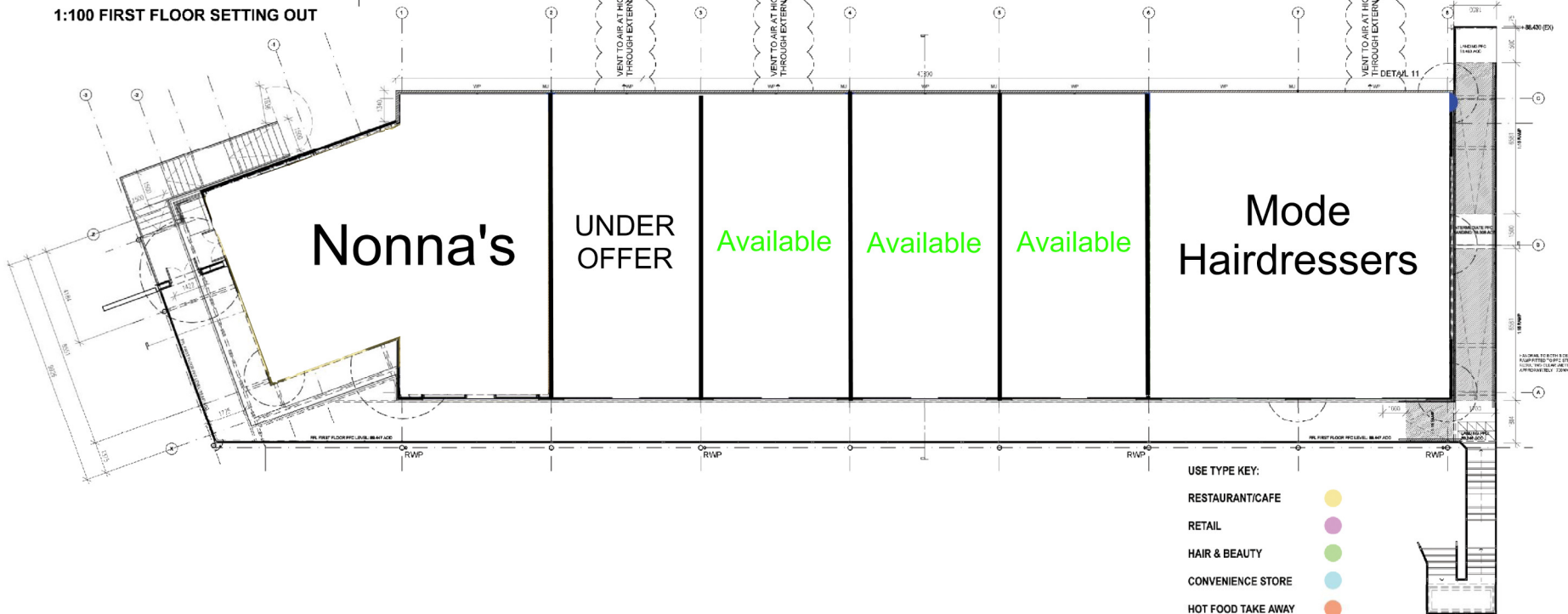

1:100 FIRST FLOOR SETTING OUT



DRAWING STATUS: CONSTRUCTION DRAWING
 DRAWN BY: JFD
 DATE: 3 OCTOBER 2007

DRAWING NOTES:
 THIS DRAWING ILLUSTRATES THE PROPOSED SETTING OUT OF THE GROUND AND FIRST FLOOR PLANS FOR 131 CHATSWORTH ROAD.
 VERTICAL MOVEMENT JOINTS WITHIN BRICKWORK SHOWN ON PLAN. INDIVIDUAL BLOCKWORK PANELS BROKEN ACROSS COLUMN POSITIONS AND SO NO ADDITIONAL JOINTS REQUIRED UNLESS SPECIFICALLY MARKED.
 TO BE READ IN CONJUNCTION WITH (2)1 SERIES DRAWINGS FOR INDIVIDUAL PLAN DETAILS AS HIGHLIGHTED ON PLAN.
 SVP SETTING OUT DIMENSIONS ILLUSTRATED ON DRAWING (1)-05.

REVISION:
REVISION K - 15 MARCH 2008 - JD
 DRAWING UPDATED FOLLOWING SITE MEETING HELD 14 MARCH 2008 - REBATE 1'5" OVER SETTING TO AIR AT HIGH LEVEL THROUGH EXTERNAL WALL (BASED ON EASTWOODS DRAWING 2/0000 REV C) FIRE SHUTTER NOTE ADDED TO GROUND FLOOR. SLIDING FOLDING SCREEN METERS HOUSE POSITION ADJUSTED.
REVISION J - 4 MARCH 2008 - JD
 Precise existing door from unit 29 to unit 29 - re-locate the glazing panel to the original 2' screen.
REVISION I - 28 FEBRUARY 2008 - JD
 Proposed internal partition wall between units 14 & 15 to create external entrance door positions & quality confirmed. Re-locate existing doors to 6' 6" to units 14 & 15 respectively. Provide new doors to units 24 & 25 - Re-locate glazing to units 14 & 15 where existing doors have been removed.
REVISION G - 5 FEBRUARY 2008 - JD
 Benjo proposed - removed from drawing - new shown on drawing sheet. Glass existing location shown on first floor plan via red dot.
REVISION F - 11 JANUARY 2008 - JD
 Drawing updated to include additional units provided within the internal partition walls as client instruction received 10 January 2008.
REVISION E - 9 JANUARY 2008 - JD
 Drawing updated to include internal partition walls as defined by client instruction received 9 January 2008.
REVISION D - 4 JANUARY 2008 - JD
 Drawing updated with metric setting out and production of drawings 1:10 issued previously.
REVISION C - 17 DECEMBER 2007
 Proposed Benjo unit & meter access shown on plan with provisional enclosure details added.
REVISION B - 28 NOVEMBER 2007
 Proposed preferred locations for future staircase locations (shown in red) such cost as a whole in the first instance with reinforcement provided to slab edges to allow future removal - Positions to be confirmed as acceptable by the employer prior to implementation on site.
 additional service riser locations also shown in blue - Positions to be confirmed as acceptable by the employer prior to implementation on site.
REVISION A - 26 NOVEMBER 2007
 Provision made for future staircase locations, the cost as a whole in the first instance with reinforcement provided to slab edges to allow future removal - Positions to be confirmed as acceptable by the employer prior to implementation on site.

PROJECT: 131 CHATSWORTH ROAD, CHESTERFIELD
CLIENT: BLUEDEER LTD
DWG TITLE: FLOOR PLAN SETTING OUT & DETAIL / SECTION MARKERS
DWG SCALE: 1:100 @ A1
DWG NO: CHRD, (1)-03
REV: K
 UNITS CENTRE, 85 BULL HILL ROAD, SHEFFIELD, S8 5SD
 TEL: 0114 2664433; E-MAIL: info@jamesmurray.co.uk

